



# МАШИНС 55

СИЛА. НАДЁЖНОСТЬ. ТОЧНОСТЬ



[www.machines55.ru](http://www.machines55.ru)



[machines55](https://www.instagram.com/machines55)





МАШИНС 55

СИЛА. НАДЕЖНОСТЬ. ТОЧНОСТЬ

## Company profile

MASHINS55, LLC – a company, specializing in production of special parts and nodes from various ranks of steel for the energy, nuclear, chemical, oil, gas, machine-building, mining industries and enterprises of the military-industrial complex.

On the basis of our company profile, we are ready to offer our partners products which are corresponded to national and foreign standards (ASME, (ANSI), DIN). The necessity and importance for such details of pipelines is determined with the widespread usage of imported parts and nodes exercised in the pipelining networks.



МАШИНС SS

СИЛА. НАДЕЖНОСТЬ. ТОЧНОСТЬ

Company's  
activity directions

**The main direction of our company activity** is the manufacture of products for individual customers' orders. Our productive capacity and technological equipment allow us to produce any unique products based on your sketches and drawings. Moreover, our qualified experts are always ready to advise you on all possible issues, associated with the use of parts according to accepted standards – ANSI, (ASME), DIN, EN, TC, IS, STE.

Applying rapid response on demand changing and following the pipeline parts trends in the international market, our production system (with the wide machine park, various technologies and methods for the manufacture of pipelines) allow us to create a part with the customer's request.



The priorities for the development of the production capacities of our company are the consistently high quality of products and contract performance.

The development of the production is achieved through:

- Equipment upgrade
- Advanced training of employees
- Introduction and application of the organization modern forms of production
- Quality control systems
- Professional and highly-qualified management

MASHINS55, LLC uses advanced technologies for the production of turned, welded and stamp-welded transitions, tees, flanges, plugs, bends and bottoms from forgings, long products, pips and our own casting.



МАШИНС 55  
СУЛА. НАГЁЖНОСТЬ. ТОЧНОСТЬ

## Divisions

Quality Assurance Department (QAD)

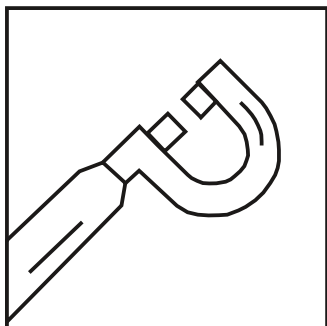

Engineering and Design Department (EDD)

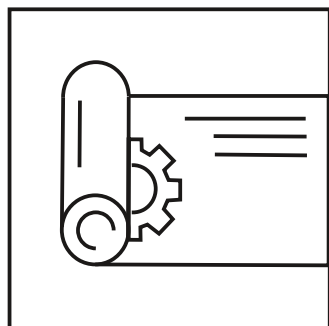

The foundry

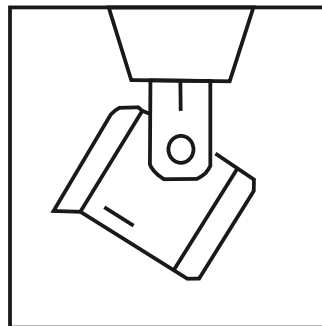

Stamp-welding workshop

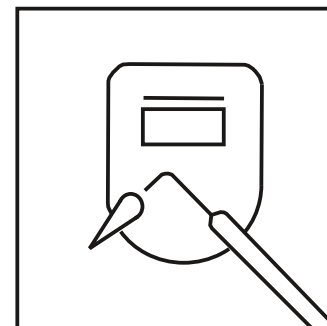

Hammer workshop

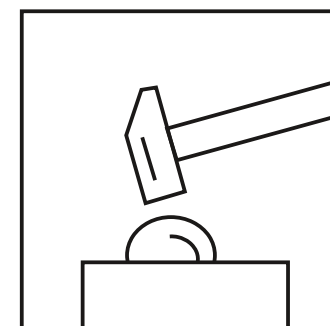

Machine workshop

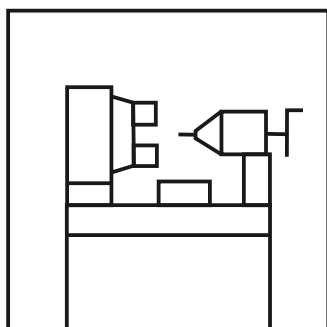

Numerical Control Department (NCD)

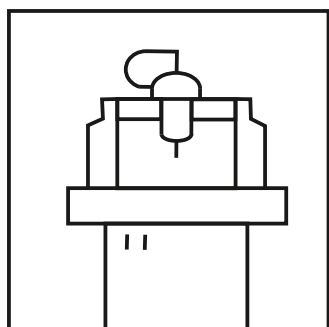

Heat-treatment cell

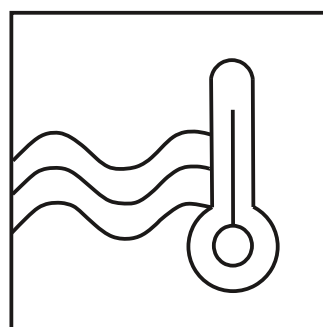

Precision casting cell

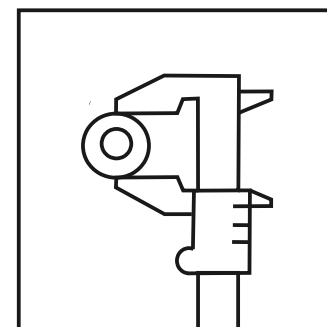

Accredited laboratory

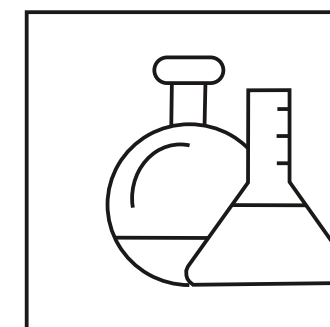



The company's products are welded, stamp-welded and seamless pipeline parts:

- Rolling of sheets and shells from a diameter of 530 mm.
- Stamp-welded tees according to TC 1468-001-80998892 2009, TC 24.20.40-002-90283533-2018
- Welded tees according to IS 36-24-77, TC 1468001-80998892 2009, TC 24.20.40-002-90283533-2018
- Turned and stamped seamless tees according to RNS 17376-2001, 22822-83 and others.
- Turned and stamped tees according to IS CBTI 720.08-2009, IS CBTI 720.10-2009, IS CBTI 720.01-2009, IS CBTI 720.02-2009, IS CBTI 720.15-2009, IS CBTI 720.16-2009.
- Welded transitions according to IS 36-22-77, TC 1468-001 8098892-2009, TC 24.20.40.002-90283533-2018.



- Stamp-welded transitions according to TC 1468-002 80998892-2009, TC 24.20.40.002-90283533-2018.
- Welded sector bends according to IS 36-21-77, TU 1468 002-80998892-2009, TC 24.20.40.002-90283533-2018.
- Flanges according to RNS 9399-81, RNS 33259-2015, ASME/ANSI 16.5
- Plugs, bottoms according to SS 17379-2001, RNS 6533-78, RNS 22815-83, ASD 24.200.02-90 ASME / ANSI 16.5

#### Steel Grades.

Carbon and Low-Alloy Steel: A105, A106Gr.B, A234Gr.WPB, A350Gr.LF2, A420Gr.WPL6;

High Temperature: A182Gr.F5, A182Gr.F9, A182Gr.F12, A182Gr.F22, A234Gr.WP5, A234Gr.WP9, A234Gr.WP12, A234Gr.WP22;

Stainless Steel: A182Gr.F304, A182Gr.F316, A182Gr.F321, A182Gr.F347, A403Gr.WP304, A403Gr.WP316, A403Gr.WP321, A403Gr.WP347



Hot water steam pipelines of thermal power plants

Turned transitions for pipelines of steam and hot water of thermal stations

- IS CBTI 318.01-2009
- IS CBTI 318.04-2009

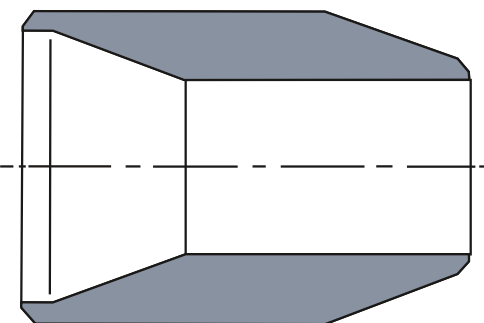

Crimped transitions for pipelines of steam and hot water of thermal stations

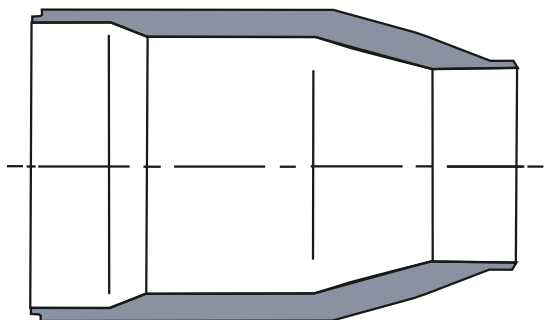

- IS CBTI 318.02-2009
- IS CBTI 318.05-2009



Fitting connections or pipelines of steam and hot water thermal stations

- IS CBTI 313.01-2009
- IS CBTI 313.02-2009

Fittings for pipelines of steam and hot water of thermal stations

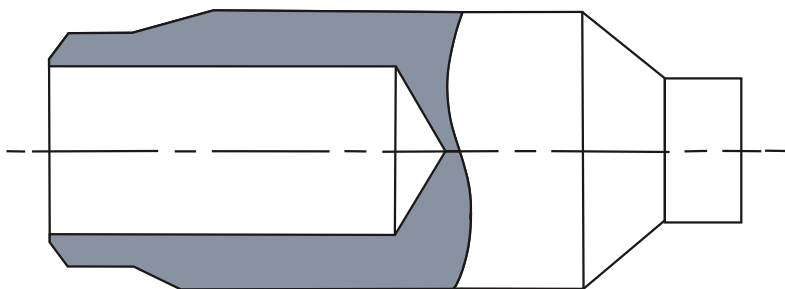

- IS CBTI 462.01-2009
- IS CBTI 462.05-2009

- IS CBTI 462.02-2009
- IS CBTI 462.06-2009

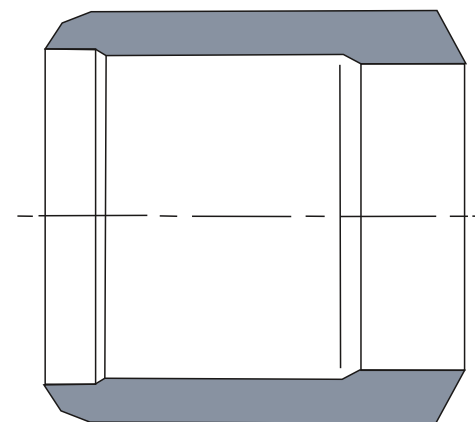

All parts are manufactured according to IS CBTI 10.003-2007.  
Pipelines of steam and hot water of thermal stations.  
General technical requirements for manufacturing.



Welded bottoms for pipelines steam  
and hot water thermal stations

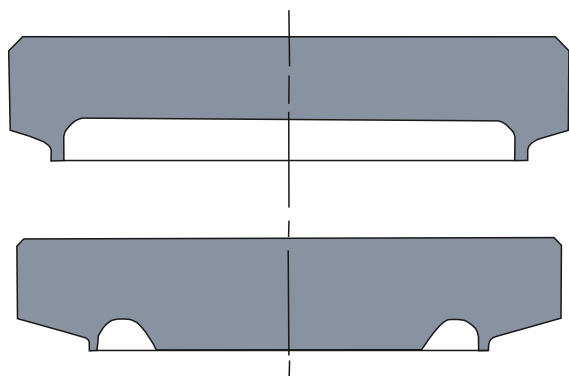

- IS CBTI 504.01-2009
- IS CBTI 504.02-2009

Welded bosses for pipelines of steam and hot water thermal stations

- IS CBTI 530.01-2009
- IS CBTI 530.02-2009

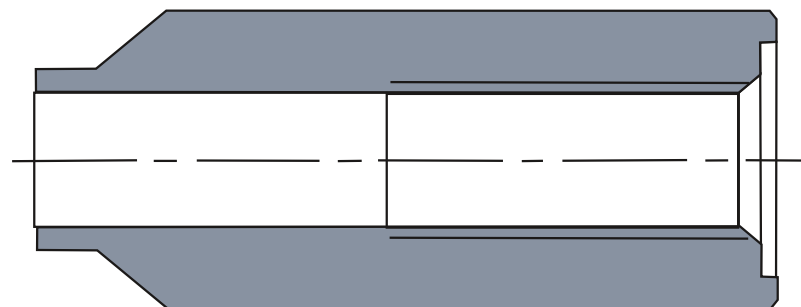



Compression tees for steam  
and hot water pipelines of thermal power plants

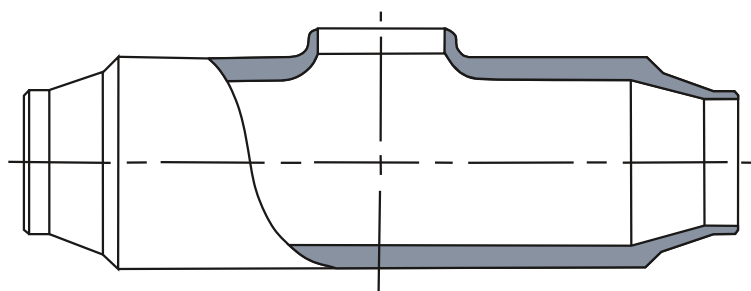

- IS CBTI 720.06-2009
- IS CBTI 720.07-2009

Long neck tees for steam and hot water pipelines thermal stations

- IS CBTI 720.08-2009
- IS CBTI 720.09-2009
- IS CBTI 720.10-2009

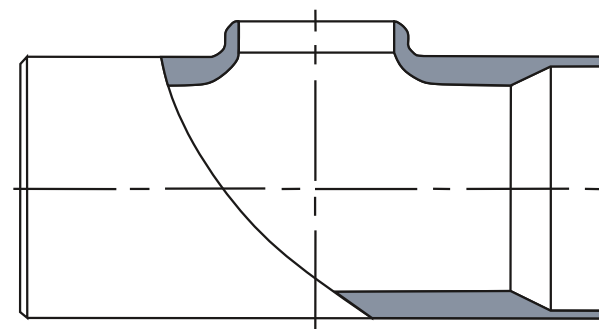

All parts are manufactured in accordance with IS CBTI 10.003-2007. Pipelines of steam  
and hot water of thermal stations. General technical requirements for manufacturing.



Assembly units of parts  
of high-pressure pipelines over 10 to 100 MPa:

Sealing and blind lenses

- SS 10493-81
- SS 22791-83

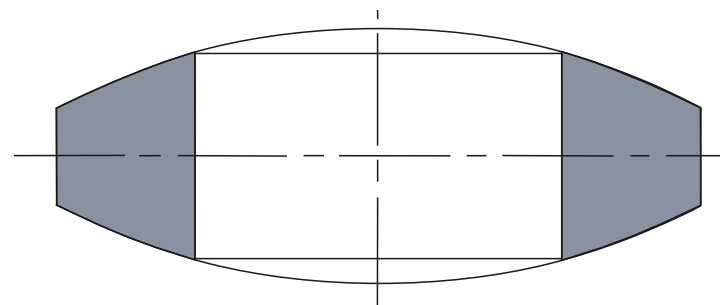

Fitting

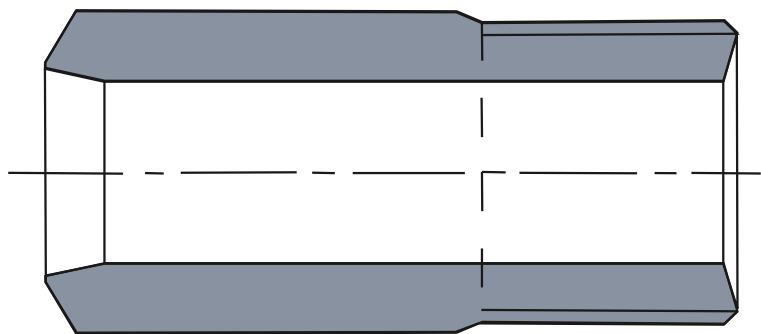

- SS 22792-83



## Elbows, elbows with branches and flanges

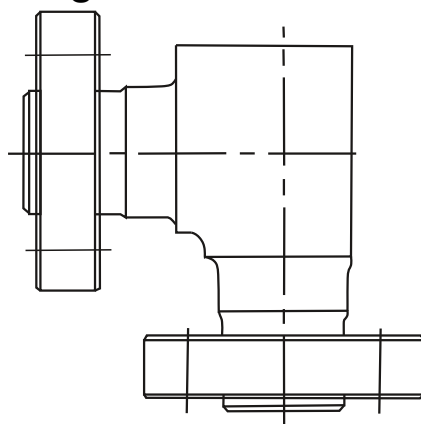

- SS 22799-83
- SS 22800-83
- SS 22820-83
- SS 22821-83

## Tees, tees-inserts, tees with branches and flanges

- SS 22801-83
- SS 22802-83
- SS 22803-83
- SS 22804-83
- SS 22805-83
- SS 22822-83
- SS 22823-83
- SS 22824-83
- SS 22825-83

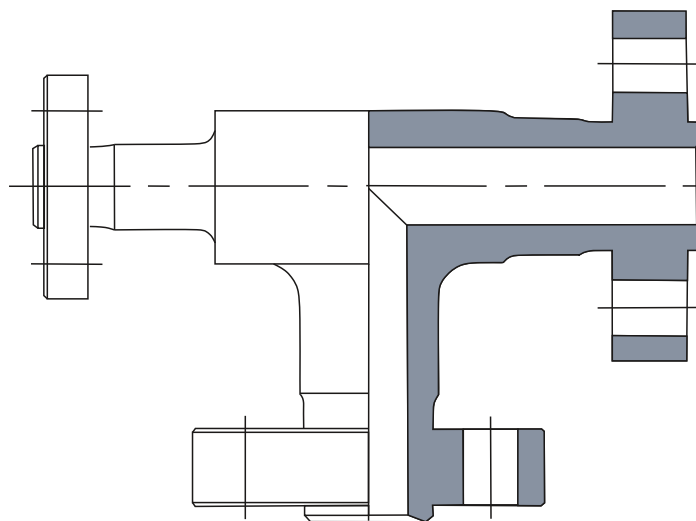

All parts are manufactured in accordance with IS CBTI 10.003-2007 Pipelines of steam and hot water of thermal stations. General technical requirements for manufacturing.



## Reducers (transitions), reducers with flanged

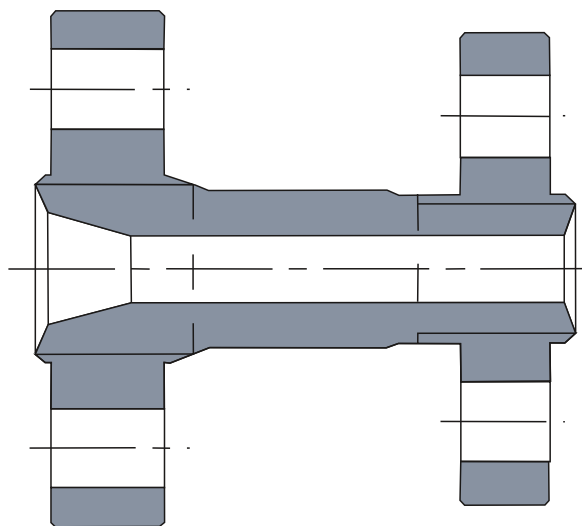

- SS 22806-83
- SS 22826-83

## Adapter flanges, adapter flanges with inserts and flange plugs

- SS 22813-83
- SS 22814-83
- SS 22815-83
- SS 22816-83

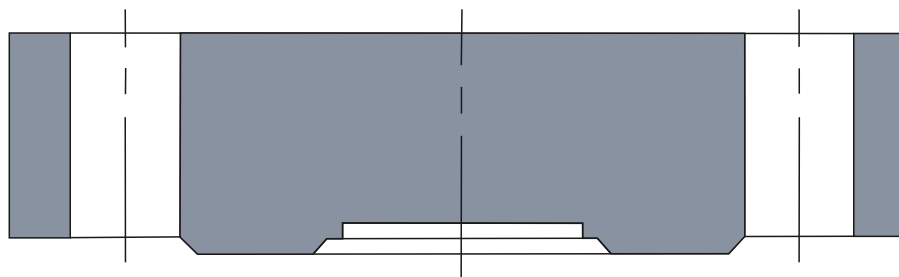



Technological pipelines for various purposes up to 100 MPa

Seamless, stamped, welded and stamp-welded tees



- ASME B16.5
- IS 36-23-77
- IS 36-24-77
- TC 1468-001-80998892-2009
- TC 24.20.40-002-90283533-2018
- SS 17376-2001

Seamless, stamped, welded and stamp-welded reducers

- ASME B16.9
- IS 36-22-77
- TC 1468-001-80998892-2009
- TC 24.20.40-002-90283533-2018
- SS 17376-2001





МАШИНС 55  
СУЛА. НАГЁЖНОСТЬ. ТОЧНОСТЬ

Products (contd.)

## Elliptical plugs, stamped bottoms



- ASME B16.9
- TC 1468-001-80998892-2009
- TC 24.20.40-002-90283533-2018
- SS 17379-2001

Pipeline's parts are made of steel - A350Gr.LF2, A420Gr.WPL6, A182Gr.F5, A234Gr.WP22, A182Gr.F321, A182Gr.F347, A403Gr.WP304 and other grades as agreed with the customer. Possibility to manufacture details with connecting dimensions according to ASMEB16.25.

## Flanges, swivel and flanged plugs

- ASME B16.5
- ASME B16.48
- SS 33259-2015
- ASD 24.200.02-90
- ASD 26-18-5-93

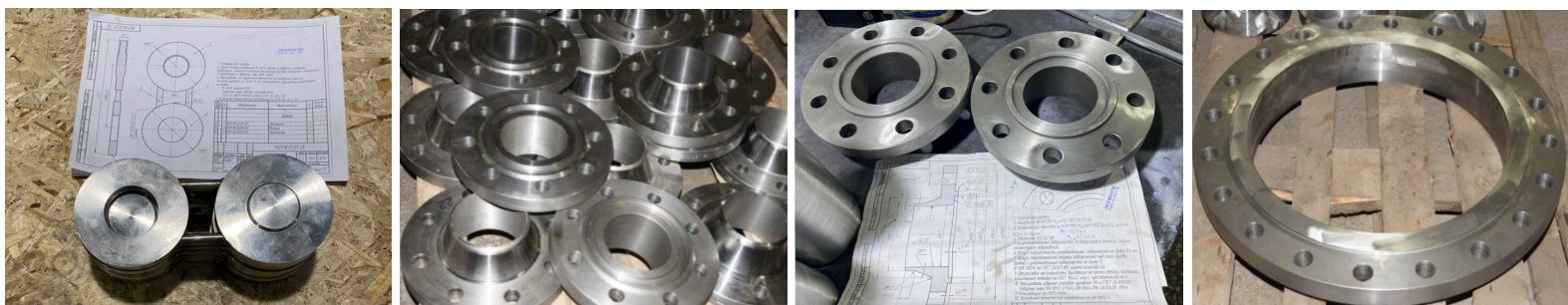



### Welded sector elbows



- TC 1468-001-80998892-2009
- TC 24.20.40-002-90283533-2018

### Piping assemblies and parts with rings



- TC 1468-001-80998892-2009
- TC 24.20.40-002-90283533-2018

Pipeline's parts are made of steel - A350Gr.LF2, A420Gr.WPL6, A182Gr.F5, A234Gr.WP22, A182Gr.F321, A182Gr.F347, A403Gr.WP304 and other grades as agreed with the customer. Possibility to manufacture details with connecting dimensions according to ASMEB16.25.



МАШИНС 55  
СИЛА. НАДЕЖНОСТЬ. ТОЧНОСТЬ

Products (contd.)

Details according to customer drawings

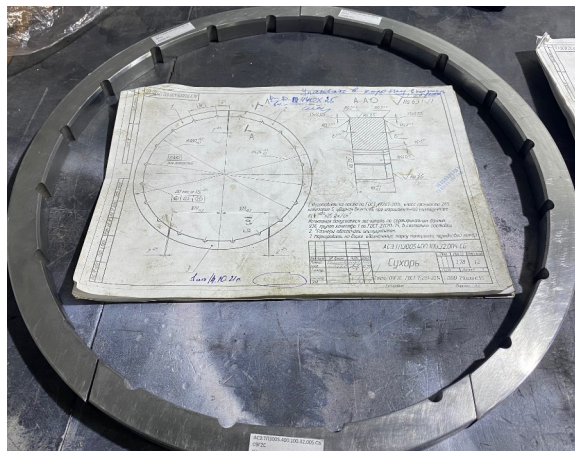

Pipeline's parts are made of steel - A350Gr.LF2, A420Gr.WPL6, A182Gr.F5, A234Gr.WP22, A182Gr.F321, A182Gr.F347, A403Gr.WP304 and other grades as agreed with the customer.



МАШИНС 55  
СУЛА. НАДЁЖНОСТЬ. ТОЧНОСТЬ

## Products (contd.)

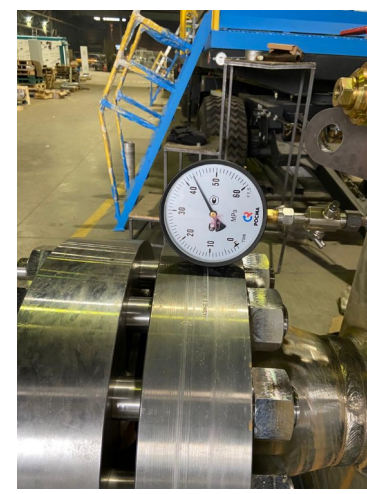

The MASHINS55, LLC production  
is complied with the Technical Regulations of the Customs Union 032/2013:  
"On the safety of equipment operating under excessive pressure"

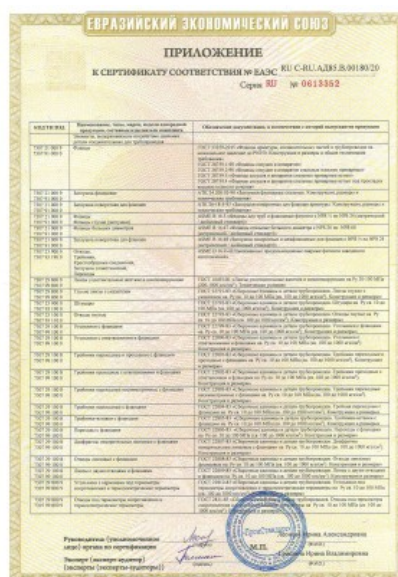
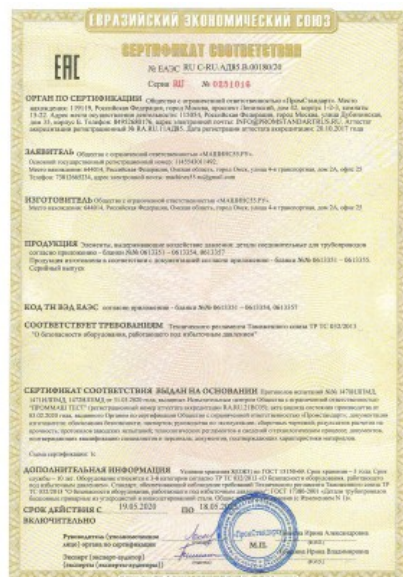



МАСИНС 55

СИЛА. НАДЕЖНОСТЬ. ТОЧНОСТЬ

Contacts

Contact us:



644021, Russian Federation, Omsk Region,

Omsk, 4-ya Transportnaya street, 2A - off 25



+7 (3812) 66-52-34 (RU)

007 (3812) 66-52-34 (International)



[www.machines55.ru](http://www.machines55.ru)



[machines55](https://www.instagram.com/machines55)